



TIMECON INSTRUMENTS



PRODUCT CATALOGUE for **FLARELESS BITE TYPE** *Fittings & Hydraulic Accessories*

PRESSURE SWITCH

VERTICAL FLOAT SWITCH

FLOW SWITCH

AIR BREATHER

OIL WINDOW

FLOW INDICATOR

HYDRAULIC TUBE FITTING

COPPER WASHER

DIGITAL TIMER

About Us

Timecon Instruments is an ISO 9001:2000 certified company based in Faridabad, Haryana in India. We are one of the leading manufacturer of various types of Hydraulic Fittings and allied products. We cater to the diverse needs of our customers with over 250 categories of hydraulic fittings. We also have our own R&D department that enables us to provide our clients with customized products as per their specific demands. Significant experience, incessant technology upgradation, approved quality management system facilitate us to offer pre-eminent covenant to all our customers.

Our Strengths

Timecon Instruments prides itself in maintaining high quality standards for all its products and upholding customer satisfaction at all levels. Each of our product goes through a rigorous testing procedure before being cleared to be sent to client. The company has always believed in timely supply of the products at the most competitive prices earning ourselves a name in the industry. We believe in product innovations over time and thus our company keeps steadily extending its product range to cater to variable needs of our valued customers. With us, you have a reliable partner for your product needs regarding hydraulic fittings.

Quality Assurance

We take utmost care in ensuring that all our products meet the quality standards. When you buy our products you can rest assured that each and every piece has gone through a process of rigorous testing and analysis. We also are well equipped with the CNC machines along with other desired conventional machines and special purpose machines.

Technical Data and General Information

Working Principle

TI Hydraulic Fittings are Flareless Bite Type fittings constituting three components namely socket body, progressive ring (ferrule) and coupling nut.

- **Socket Body** – These bodies are of various types such straight type, elbow, tee etc. The straight type fittings are manufactured from cold drawn steel bars whereas elbows and tee are forged and further machined as per requirement.
- **Progressive Ring** – Commonly known as ferrule, this component plays a major role in allowing a firm grip of the pipe in the fitting by making two 360 degree bite into the outside diameter of the pipe, thus ensuring an unusually high degree of safety and permanent sealing making the assembly leak proof. This proper biting of the progressive rings into the pipe is ensured by precision machining and heat treatment.
- **Coupling Nut** – The coupling nut are responsible for pushing the progressive ring onto the tube when tightened and ensuring a strong reliable connection. These nuts are manufactured from cold drawn material and are either cold or hot formed or machined to size as per requirements

Hydraulic Fitting Classification

TI-HF Flareless Bite Type Fittings are available from 6mm OD of tube to 43mm OD of tube in low pressure series i.e. 'L' and 6mm OD to 38mm OD of tube in high pressure series i.e. 'S'. These are also available for use with Nominal Bore of Tube from 1/8" to 1-1/2" and OD of tube from 3/16" to 2".

Contents:

S.No.	Description	Page No.
1	Cap Nut & Ferrule	4
2	Straight Coupling	5
3	Unequal Straight Coupling	6
4	Male Stud Coupling	7
5	Male Stud Coupling (Cont.)	8
6	Male Stud Coupling with Elastomeric Seal	9
7	Taper Male Stud Coupling	10
8	Welding Connector	11
9	Equal Elbow	12
10	Male Stud Elbow	13
11	Swivel Elbow	14
12	Swivel Elbow with connector	15
13	Equal Tee	16
14	Male Stud Tee	17
15	Swivel Tee	18
16	Swivel Tee with connector	19
17	Equal Cross	20
18	Bulk Head Coupling	21
19	Bulk Head Elbow	22
20	Welding BulkHead Coupling	23
21	Banjo	24
22	Throttle Free Banjo	25
23	Female Connector	26
24	Tube Reducer	27
25	Tube Reducer (cont.)	28
26	Pressure Gauge Connector	29
27	Blanking Plug	30

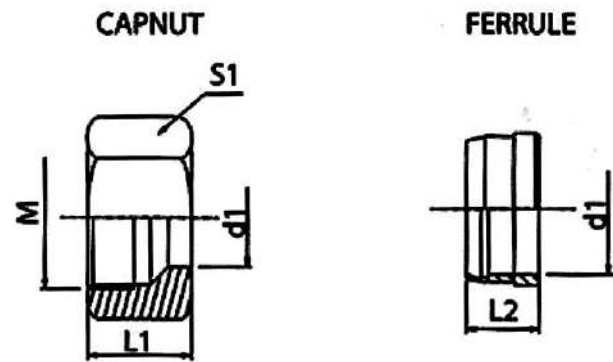
**CAPNUT & FERRULE
CN & F**

TUBE OD D1	WORKING PRESSURE	M	L1	S1	PART NO CAPNUT	L2	PART NO.
6	L	M12X1.5	15	14	TI-CN-6L	9	TI-F-6L
8	LIGHT	M14X1.5	15	17	TI-CN-8L	9	TI-F-8L
10	MAX 250	M16X1.5	16	19	TI-CN-10L	9.5	TI-F-10L
12	BAR	M18X1.5	16	22	TI-CN-12L	10	TI-F-12L
15		M22X1.5	17.5	27	TI-CN-15L	10	TI-F-15L
18		M26X1.5	18.5	32	TI-CN-18L	10.5	TI-F-18L
22	MAX 100	M30X2	20.5	36	TI-CN-22L	11	TI-F-22L
28	BAR	M36X2	21	41	TI-CN-28L	11	TI-F-28L
35		M45X2	24	50	TI-CN-35L	12.5	TI-F-35L
42		M52X2	24	60	TI-CN-42L	12.5	TI-F-42L
6	S	M14X1.5	17	17	TI-CN-6S	9	TI-F-6S
8	HEAVY	M16X1.5	17	19	TI-CN-8S	9	TI-F-8S
10	MAX 500	M18X1.5	18	22	TI-CN-10S	9.5	TI-F-10S
12	BAR	M20X1.5	18	24	TI-CN-12S	10	TI-F-12S
14		M22X1.5	21	27	TI-CN-14S	10	TI-F-14S
16		M24X1.5	21	30	TI-CN-16S	10	TI-F-16S
20	MAX 400	M30X2	24.5	36	TICN-20S	11	TI-F-20S
25	BAR	M36X2	27	46	TI-CN-25S	11	TI-F-25S
30	MAX 200	M42X2	29	50	TI-CN-30S	12	TI-F-30S
38	BAR	M52X2	32.5	60	TI-CN-38S	12.5	TI-F-38S

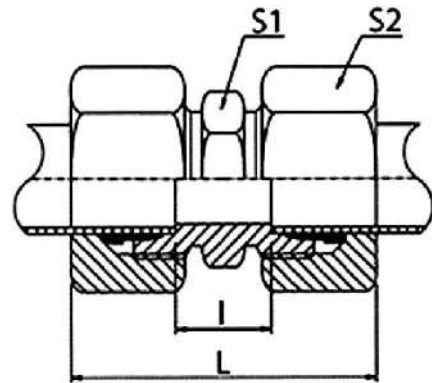
**STRAIGHT COUPLING
SC**

Tube OD IN MM	Working Pressure	I	L	S1	S2	Part No.
6	L	10	39	12	14	TI-SC-6L
8	Light	11	40	14	17	TI-SC-8L
10	Max 250	13	42	17	19	TI-SC-10L
12	Bar	14	43	19	22	TI-SC-12L
15		16	46	24	27	TI-SC-15L
18		16	48	27	32	TI-SC-18L
22	Max 100	20	52	32	36	TI-SC-22L
28	Bar	21	54	41	41	TI-SC-28L
35		20	63	46	50	TI-SC-35L
42		21	66	55	60	TI-SC-42L
6	S	16	45	14	17	TI-SC-5S
8	Heavy	18	47	17	19	TI-SC-8S
10	Max 500	17	49	19	22	TI-SC-10S
12	Bar	19	51	22	24	TI-SC-12S
14		22	57	24	27	TI-SC-14S
16	Max 400	21	57	27	30	TI-SC-16S
20	Bar	23	66	32	36	TI-SC-20S
25		26	74	41	46	TI-SC-25S
30	Max 200	27	80	46	50	TI-SC-30S
38	Bar	29	90	55	60	TI-SC-38S

*Dimensions given are approx. figures with tightened nut.

UNEQUAL STARIGHT COUPLING USC

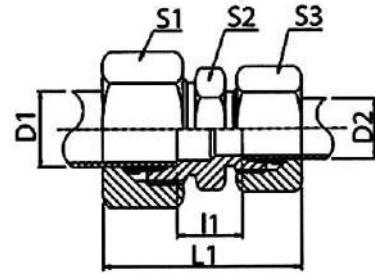

OD of Tube D1	OD of Tube D2	Working Pressure	l ₁	L1	S1	S2	S3	PART NO.
8	6	L LIGHT MAX 250 BAR	11	40	17	14	14	TI-USC-8L/6L
10	6		12	41	19	17	14	TI-USC-10L/6L
10	8		12	41	19	17	17	TI-USC-10L/8L
12	6		13	42	22	19	14	TI-USC-12L/6L
12	8		13	42	22	19	17	TI-USC-12L/8L
12	10		14	43	22	19	19	TI-USC-12L/10L
15	10		15	45	27	24	19	TI-USC-15L/10L
15	12		15	45	27	24	22	TI-USC-15L/12L
18	10		15.5	46	32	27	19	TI-USC-18L/10L
18	12		15.5	46	32	27	22	TI-USC-18L/12L
18	15	16.5	48	32	27	27	TI-USC-18L/15L	
22	12	MAX 100 BAR	17.5	48	36	32	22	TI-USC-22L/12L
22	15		18.5	50	36	32	27	TI-USC-22L/15L
22	18		18	50	36	32	32	TI-USC-22L/18L
28	18		19	52	41	41	32	TI-USC-28L/18L
28	22		21	54	41	41	36	TI-USC-28L/22L
35	22		21	59	50	46	36	TI-USC-35L/22L
35	28		21	59	50	46	41	TI-USC-35L/28L
8	6	S HEAVY MAX 500 BAR	18	47	19	17	17	TI-USC-8S/6S
10	6		17.5	48	22	19	17	TI-USC-10S/6S
10	8		17.5	48	22	19	19	TI-USC-10S/8S
12	6		19.5	50	24	22	17	TI-USC-12S/6S
12	8		19.5	50	24	22	19	TI-USC-12S/8S
12	10		19	51	24	22	22	TI-USC-12S/10S
14	10		20.5	54	27	24	22	TI-USC-14S/10S
14	12		20.5	54	27	24	34	TI-USC-14S/12S
16	12	MAX 400 BAR	20	54	30	27	24	TI-USC-16S/12S
16	14		21.5	57	30	27	27	TI-USC-16S/14S
20	10		22	60	36	32	22	TI-USC-20S/10S
20	12		22	60	36	32	24	TI-USC-20S/12S
20	16		23	63	36	32	30	TI-USC-20S/16S
25	16		25.5	68	46	41	30	TI-USC-25S/16S
25	20		25.5	71	46	41	36	TI-USC-25S/20S
30	20	MAX 200 BAR	26	74	50	46	36	TI-USC-30S/20S
30	25		26.5	77	50	46	46	TI-USC-30S/25S
38	30		29.5	87	60	55	60	TI-USC-38S/30S

*Dimensions given are approx. figures with tightened nut.

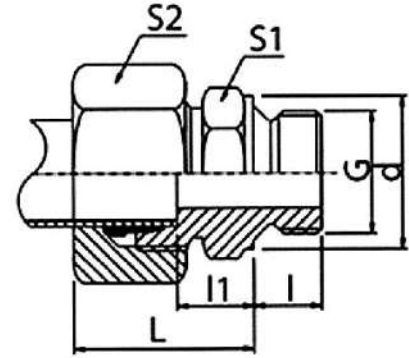
**MALE STUD COUPLING
MSB/MSM**

OD of Tube	Working Pressure	G (Thread AT Plugend)		d	I	I ₁	L1	S1	S2	Part No. For BSP Plug End
		BSSP	METRIX							
6	L LIGHT MAX 250 BAR	1/8"	M10X1	14	8	8.5	23	14	14	TI-MSB-6L-1/8
6		1/4"		19	12	10	25	19	14	TI-MSB-6L-1/4
6		3/8"		22	12	11.5	26	22	14	TI-MSB-6L-3/8
8		1/8"	M12X1.5	17	8	8.5	23	17	17	TI-MSB-8L-1/8
8		1/4"		19	12	10	25	19	17	TI-MSB-8L-1/4
8		3/8"		22	12	11.5	26	22	17	TI-MSB-8L-3/8
10		1/8"		17	8	11	24	17	19	TI-MSB-10L-1/8
10		1/4"	M14X1.5	19	12	11	26	19	19	TI-MSB-10L-1/4
10		3/8"		22	12	12.5	27	22	19	TI-MSB-10L-3/8
10		1/2"		27	14	13	28	27	19	TI-MSB-10L-1/2
12		1/4"		19	12	12	27	19	22	TI-MSB-12L-1/4
12		3/8"	M16X1.5	22	12	12.5	27	22	22	TI-MSB-12L-3/8
12		1/2"		27	14	13	28	27	22	TI-MSB-12L-1/2
15		3/8"	M20X1.5	24	12	13.5	29	24	27	TI-MSB-15L-3/8
15		1/2"		27	14	14	29	27	27	TI-MSB-15L-1/2
18		3/8"	M22X1.5	24	12	14	29.5	27	32	TI-MSB-18L-3/8
18		1/2"		27	14	14.5	31	27	32	TI-MSB-18L-1/2
18		3/4"		32	16	14.5	32.5	32	32	TI-MSB-18L-3/4
22	MAX 100 Bar	1/2"	M26X1.5	32	14	16.5	33	32	36	TI-MSB-22L-1/2
22		3/4"		32	16	16.5	33	32	36	TI-MSB-22L-3/4
22		1"		41	18	17.5	35	41	36	TI-MSB-22L-1
28		3/4"		32	16	17.5	34	41	41	TI-MSB-28L-3/4
28		1"	M33X2	41	18	17.5	34	41	41	TI-MSB-28L-1
35		1"		41	18	17.5	39	50	50	TI-MSB-35L-1
35		1 1/4"	M42X2	39	20	17.5	39	50	50	TI-MSB-35L-11/4
42		1 1/2"	M48X2	55	22	19	41	55	60	TI-MSB-42L-11/2

*Dimension given are approx. Figures with tightened nut.
For Metric thread, replace MSB by MSM

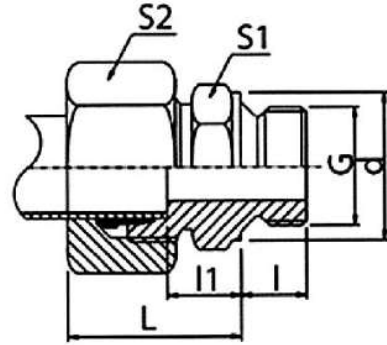
**MALE STUD COUPLING
MSB/MSM**

OD of Tube	Working Pressure	G (Thread AT Plugend)		d	l	l ₁	L ₁	S ₁	S ₂	Part No. For BSP Plug End	
		BSP	METRIC								
6	S HEAVY MAX 350 BAR	1/4"	M12X1.5	19	12	13	28	19	17	TI-MSB-6S-1/4	
6		3/8"		22	12	13	28	22	17	TI-MSB-6S-3/8	
6		1/2"		27	14	18	33	27	17	TI-MSB-6S-1/2	
8		1/4"	M14X1.5	19	12	15	30	19	19	TI-MSB-8S-1/4	
8		3/8"		22	12	15.5	30	22	19	TI-MSB-8S-3/8	
8		1/2"		27	14	18.5	33	27	19	TI-MSB-8S-1/2	
10		1/4"		19	12	14.5	31	19	22	TI-MSB-10S-1/4	
10		3/8"	M16X1.5	22	12	15	31	22	22	TI-MSB-10S-3/8	
10		1/2"		27	14	17.5	34	27	22	TI-MSB-10S-1/2	
12		1/4"		22	12	16.5	33	19	24	TI-MSB-12S-1/4	
12		3/8"	M16X1.5	22	12	17	33	22	24	TI-MSB-12S-3/8	
12		1/2"	M22X1.5	27	14	17.5	34	27	24	TI-MSB-12S-1/2	
14		3/8"		22	12	18.5	36	24	27	TI-MSB-14S-3/8	
14		1/2"	M20X1.5	27	14	19	37	27	27	TI-MSB-14S-1/2	
16		MAX 200 BAR	3/8"	M22X1.5	22	12	18	36	27	30	TI-MSB-16S-3/8
16			1/2"		27	14	18.5	37	27	30	TI-MSB-16S-1/2
16			3/4"		32	16	20.5	39	32	30	TI-MSB-16S-3/4
20			1/2"		27	14	20.5	42	32	36	TI-MSB-20S-1/2
20	3/4"		M27X2	32	16	20.5	42	32	36	TI-MSB-20S-3/4	
20	1"			41	18	22	43.5	41	36	TI-MSB-20S-1	
25	3/4"			32	16	23	47	41	46	TI-MSB-25S-3/4	
25	1"		M33X2	41	18	23	47	41	46	TI-MSB-25S-1	
25	1 1/4"			49	20	23.5	47.5	50	46	TI-MSB-25S-11/4	
30	1"			41	18	23.5	50	46	50	TI-MSB-30S-1	
30	1 1/4"	M42X2	49	20	23.5	50	50	50	TI-MSB-30S-11/4		
38	MAX 120 BAR	1 1/4"		49	20	38	57	50	60	TI-MSB-38S-11/4	
38		1 1/2"	M48X2	55	22	38	57	55	60	TI-MSB-38S-11/2	

*Dimension given are approx. Figures with tightened nut.
For Metric thread, replace MSB by MSM

MALE STUD COUPLING WITH ELASTOMERIC SEAL MSB-ED

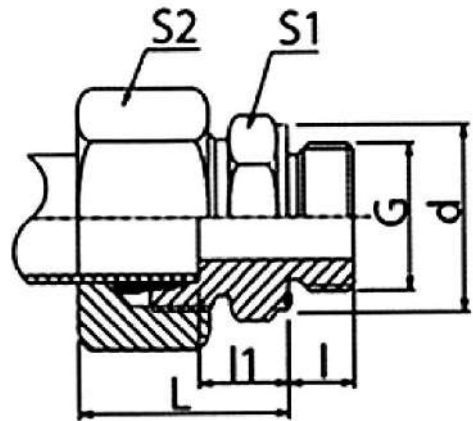

OD of Tube	Working Pressure	G BSPP	d	l	l ₁	L1	S1	S2	Part No.
6	L LIGHT MAX 250 BAR	1/8"	14	8	8.5	23	14	14	TI-MSB-6L-1/8-ED
8		1/4"	19	12	10	25	19	17	TI-MSB-8L-1/4-ED
10		1/4"	19	12	11	26	19	19	TI-MSB-10L-1/4-ED
12		3/8"	22	12	12.5	27	22	22	TI-MSB-12L-3/8-ED
15		1/2"	27	14	14	29	27	27	TI-MSB-15L-1/2-ED
18		1/2"	27	14	14.5	31	27	32	TI-MSB-18L-1/2-ED
22	MAX 100	3/4"	32	16	16.5	33	32	36	TI-MSB-22L-3/4-ED
28	BAR	1"	41	18	17.5	34	41	41	TI-MSB-28L-1-ED
35		1 1/4"	50	20	17.5	39	50	50	TI-MSB-35L-1 1/4-ED
42		1 1/2"	55	22	19	42	55	60	TI-MSB-42L-1 1/2-ED
6	S	1/4"	19	12	13	28	19	17	TI-MSB-6S-1/4-ED
8	HEAVY	1/4"	19	12	15	30	19	19	TI-MSB-8S- 1/4-ED
10	MAX 350	3/8"	22	12	15	31	22	22	TI-MSB-10S-3/8-ED
12	BAR	3/8"	22	12	17	33	22	24	TIMSB-12S-3/8-ED
14		1/2"	27	14	19	37	27	27	TI-MSB-14S-1/2-ED
16	MAX 200	1/2"	27	14	18.5	37	27	30	TI-MSB-16S-1/2-ED
20	BAR	3/4"	32	16	20.5	42	32	36	TI-MSB-20S-3/4-ED
25		1"	41	18	23	47	41	46	TI-MSB-25S-1-ED
30	MAX 120	1 1/4"	50	20	23.5	50	50	50	TI-MSB-30S-1 1/4-ED
38	BAR	1 1/2"	55	22	26	57	55	60	TI-MSB-38S-11/2-ED

*Dimensions given are approx. figures with tightened nut.
Other combinations can also be supplied.

TAPER MALE STUD COUPLING MST/MSN

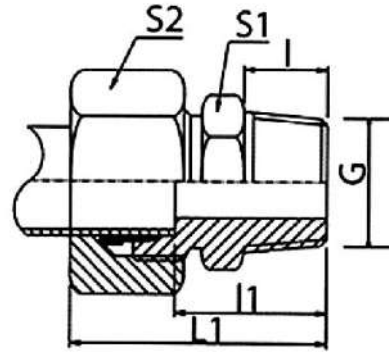

OD of Tube	Working Pressure	G BSP / NPT	l	l ₁	L ₁	S ₁	S ₂	Part No. For BSPT Plug End
6	L LIGHT MAX 250 BAR	1/8"	8	15	30	12	14	TI-MST-6L-1/8
6		1/4"	12	19	34	14	14	TI-MST-6L-1/4
8		1/4"	12	20	35	17	17	TI-MST-8L-1/4
10		1/4"	12	21	36	17	19	TI-MST-10L-1/4
12		1/4"	12	22	37	19	22	TI-MST-12L-1/4
12		3/8"	12	22	37	19	22	TI-MST-12L-3/8
12		1/2"	14	24	39	24	22	TI-MST-12L-1/2
15		3/8"	12	23	38	24	27	TI-MST-15L-3/8
15		1/2"	14	25	40	24	27	TI-MST-15L-1/2
18		MAX 100	1/2"	14	25.5	41	27	32
22	BAR	3/4"	16	29.5	46	32	36	TI-MST-22L-3/4
28		1"	18	33	49	41	41	TI-MST-28L-1
35		1 1/4"	20	35.5	57	46	50	TI-MST-35L-1 1/4
42		1 1/2"	22	38	61	55	60	TI-MST-42L-1 1/2
6	s	1/4"	12	22	38	17	17	TI-MST-6S-1/4
8	HEAVY	1/4"	12	22	38	17	19	TI-MST-8S-1/4
10	MAX 350	3/8"	12	24	41	19	22	TI-MST-10S-3/8
12	BAR	3/8"	12	26	43	22	24	TI-MST-12S-3/8
14		1/2"	14	31	46	24	27	TI-MST-14S-1/2
16	MAX 200	1/2"	14	31	46	27	30	TI-MST-16S-1/4
20	BAR	3/4"	16	34	55	32	36	TI-MST-20S-3/4
25		1"	18	39	62	41	46	TI-MST-25S-1
30	MAX 120	1 1/4"	20	42	69	46	50	TI-MST-30S-1 1/4
38	BAR	1 1/2"	22	45	76	55	60	TI-MST-38S-1 1/2

*Dimensions given are approx. figures with tightened nut.
For NPT threads, replace MST by MSN

WELDING CONNECTOR WC

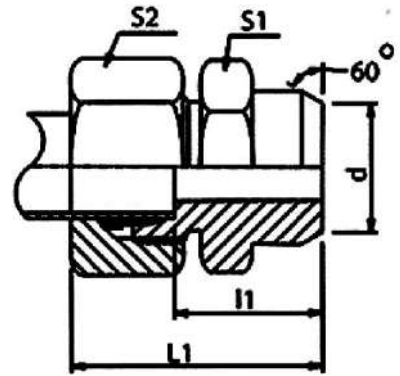

OD OF TUBE	WORKING PRESSURE	d	l ₁	L ₁	S ₁	S ₂	PART NO.
6	L	10	14	29	12	14	TI-WC-6L
8	LIGHT	12	16	31	14	17	TI-WC-8L
10	MAX 250	14	18	33	17	19	TI-WC-10L
12	BAR	16	18	33	19	22	TI-WC-12L
15		19	22	37	22	27	TI-WC-15L
18		22	23.5	40	27	32	TI-WC-18L
22	MAX 100	27	28.5	45	32	36	TI-WC-22L
28	BAR	32	30.5	47	41	41	TI-WC-28L
35		40	32.5	54	46	50	TI-WC-35L
42		46	35	58	55	60	TI-WC-42L
6	S	11	19	34	14	17	TI-WC-6S
8	HEAVY	13	21	36	17	19	TI-WC-8S
10	MAX 500	15	22.5	39	19	22	TI-WC-10S
12	BAR	17	24.5	41	22	24	TI-WC-12S
14		19	27	45	24	27	TI-WC-14S
16		21	26.5	45	27	30	TI-WC-16S
20	MAX 400	26	29.5	51	32	36	TI-WC-20S
25	BAR	31	32	56	41	46	TI-WC-25S
30	MAX 200	36	35.5	62	46	50	TI-WC-30S
38	BAR	44	38	69	55	60	TI-WC-38S

*Dimensions given are approx. figures with tightened nut.

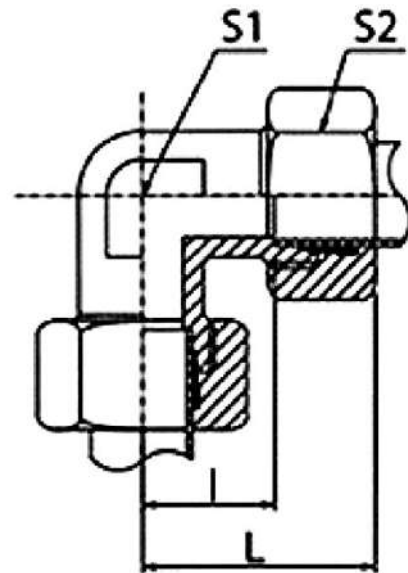
**EQUAL ELBOW
EE**

Tube OD IN MM	Working Pressure	I	L	S1	S2	Part No.
6	L	12	27	12	14	TI-EE-6L
8	Light	14	29	14	17	TI-EE-8L
10	Max 250	15	30	17	19	TI-EE-10L
12	Bar	17	32	19	22	TI-EE-12L
15		21	36	19	27	TI-EE-15L
18		23.5	40	24	32	TI-EE-18L
22	Max 100	27.5	44	27	36	TI-EE-22L
28	Bar	30.5	47	36	41	TI-EE-28L
35		34.5	56	41	50	TI-EE-35L
42		40	63	50	60	TI-EE-42L
6	S	16	31	14	17	TI-EE-6S
8	Heavy	17	32	17	19	TI-EE-8S
10	Max 500	17.5	34	19	22	TI-EE-10S
12	Bar	21.5	38	22	24	TI-EE-12S
14		22	40	22	27	TI-EE-14S
16	Max 400	24.5	43	24	30	TI-EE-16S
20	Bar	26.5	48	27	36	TI-EE-20S
25		30	54	36	46	TI-EE-25S
30	Max 200	35.5	62	41	50	TI-EE-30S
38	Bar	41	72	50	60	TI-EE-38S

*Dimension given are approx. Figures with tightened nut.

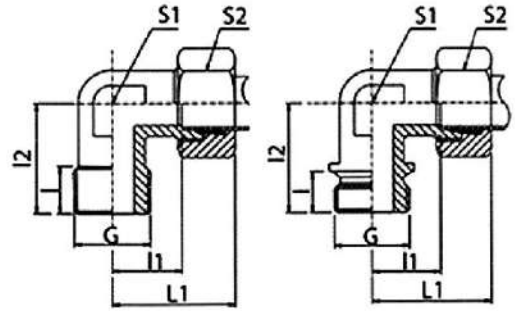
**MALE STUD ELBOW
ECT/ECB/ECN**

OD of Tube	Working Pressure	G	I	I ₁	I ₂	L1	S1	S2	Part No. For BSPT Plug End
		BSPT / NPT							
6	L LIGHT MAX 250 BAR	1/8"	8	12	20	27	12	14	TI-ECT-6L-1/8
8		1/4"	12	14	26	29	14	17	TI-ECT-8L-1/4
10		1/4"	12	15	27	30	17	19	TI-ECT-10L-1/4
12		3/8"	12	17	28	32	19	22	TI-ECT-12L-3/8
15		1/2"	14	21	34	36	19	27	TI-ECT-15L-1/2
18		1/2"	17	24	36	40	24	32	TI-ECT-18L-1/2
6	S HEAVY MAX 350 BAR	1/4"	12	16	26	31	14	17	TI-ECT-6S-1/4
8		1/4"	12	17	27	32	17	19	TI-ECT-8S-1/4
10		3/8"	12	18	28	34	19	22	TI-ECT-10S-3/8
12		3/8"	12	22	28	38	22	24	TI-ECT-12S-3/8
14		1/2"	14	22	32	40	24	27	TI-ECT-14S-1/2
16		1/2"	17	25	32	43	24	30	TI-ECT-16S-1/2

OD of Tube	Working Pressure	G	I	I ₁	I ₂	L1	S1	S2	Part No. For BSPT Plug End
		BSP / NPT							
22	L LIGHT MAX 100 BAR	3/4"	16	27.5	42	44	27	36	TI-ECB-22L-3/4
28		1"	18	30.5	48	47	36	41	TI-ECB-28L-1
35		1 1/4"	20	34.5	54	56	41	50	TI-ECB-35L-1 1/4
42		1 1/2"	22	40	61	63	50	60	TI-ECB-42L-1 1/2
20	S HEAVY MAX 200 BAR	3/4"	16	26.5	42	48	27	36	TI-ECB-20S-3/4
25		1"	18	30	48	54	36	46	TI-ECB-25S-1
30		1 1/4"	20	35.5	54	62	41	50	TI-ECB-30S-1 1/4
38	MAX 120 BAR	1 1/2"	22	41.0	61	72	50	60	TI-ECB-38S-1 1/2

*Dimensions given are approx. figures with tightened nut.
S1 may vary as per forging tol.
For NPT threads, replace ECT by ECN

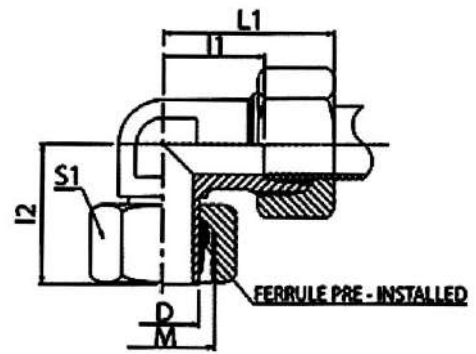
**SWIVEL ELBOW
SE**

OD of Tube	Working Pressure	M	D	I ₂	I ₁	L1	S1	PART NO.
6	L	M12X1.5	6	26	12	27	14	TI-SE-6L
8	LIGHT	M14X1.5	8	27.5	14	29	17	TI-SE-8L
10	MAX 250	M16X1.5	10	29	15	30	19	TI-SE-10L
12	BAR	M18X1.5	12	29.5	17	32	22	TI-SE-12L
15		M22X1.5	15	32.5	21	36	27	TI-SE-15L
18		M26X1.5	18	35.5	23.5	40	32	TI-SE-18L
22	L	M30X2	22	38.5	27.5	44	36	TI-SE-22L
28	LIGHT	M36X2	28	41.5	30.5	47	41	TI-SE-28L
35	MAX 100	M45X2	35	51	34.5	56	50	TI-SE-35L
42	BAR	M52X2	42	60	40	63	60	TI-SE-42L
6	S	M14X1.5	6	27	16	31	17	TI-SE-6S
8	HEAVY	M16X1.5	8	27.5	17	32	19	TI-SE-8S
10	MAX 350	M18X1.5	10	30	17.5	34	22	TI-SE-10S
12	BAR	M20X1.5	12	31	21.5	38	24	TI-SE-12S
14		M22X1.5	14	35	22	40	27	TI-SE-14S
16		M24X1.5	16	36.5	24.5	43	30	TI-SE-16S
20	MAX 200	M30X2	20	44.5	26.5	48	36	TI-SE-20S
25	BAR	M36X2	25	50	30	54	46	TI-SE-25S
30	MAX 120	M42X2	30	55	35.5	62	50	TI-SE-30S
38	BAR	M52X2	38	63	41	72	60	TI-SE-38S

*Dimensions given are approx. figures with tightened nut.

SWIVEL ELBOW WITH CONNECTOR SEP/SEM

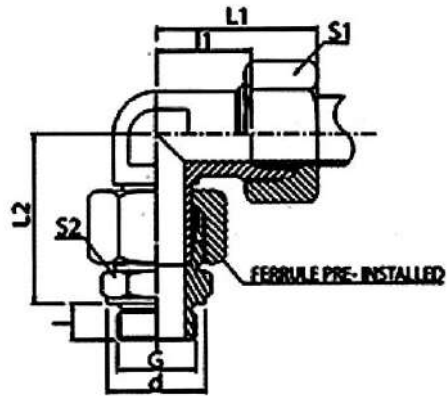

OD of Tube	Working Pressure	G. BSP	I	I1	L2	L1	S1	S2	D	Part No. BSP	G METRIC	I	L2	S2	d	Part No. METRIC
6	L	1/8"	8	12	34.5	27	14	14	14	TI-SEP-6L	M10X1	8	34.5	14	14	TI-SEM-6L
8	LIGHT	1/4"	12	14	37.5	29	17	19	18	TI-SEP-8L	M12X1.5	12	37.5	17	17	TI-SEM-8L
10	MAX 250	1/4"	12	15	40	30	19	19	18	TI-SEP-10L	M14X1.5	12	40	19	19	TI-SEM-10L
12	BAR	3/8"	12	17	42	32	22	22	22	TI-SEP-12L	M16X1.5	12	42	22	21	TI-SEM-12L
15		1/2"	14	21	46.5	36	27	27	26	TI-SEP-15L	M18X1.5	12	46	24	23	TI-SEM-15L
18		1/2"	14	23.5	50	40	32	27	26	TI-SEP-18L	M22X1.5	14	50	27	27	TI-SEM-18L
22	L	3/4"	16	27.5	55	44	36	32	32	TI-SEP-22L	M26X1.5	16	55	32	31	TI-SEM-22L
28	LIGHT	1"	18	30.5	59	47	41	41	39	TI-SEP-28L	M33X2	18	59	41	39	TI-SEM-28L
35	MAX 100	1 1/4"	20	34.5	68.5	56	50	50	49	TI-SEP-35L	M42X2	20	68.5	50	49	TI-SEM35L
42	BAR	1 1/2"	22	40	75	63	60	55	55	TI-SEP-42L	M48X2	22	75	55	55	TI-SEM-42L
6	S	1/4"	12	16	40	31	17	19	18	TI-SEP-6S	M12X1.5	12	40	17	17	TI-SEM-6S
8	HEAVY	1/4"	12	17	42.5	32	19	19	18	TI-SEP-8S	M14X1.5	12	42.5	19	19	TI-SEM-8S
10	MAX 350	3/8"	12	17.5	45	34	22	22	22	TI-SEP-10S	M16X1.5	12	45	22	21	TI-SEM-10S
12	BAR	3/8"	12	21.5	48	38	24	22	22	TI-SEP-12S	M18X1.5	12	48	24	23	TI-SEM-12S
14		1/2"	14	22	54	40	27	27	26	TI-SEP-14S	M20X1.5	14	54	29	25	TI-SEM-14S
16		1/2"	14	24.5	55	43	30	27	26	TI-SEP-16S	M22X1.5	14	55	27	27	TI-SEM-16S
20	MAX 200	3/4"	16	26.5	65	48	36	32	32	TI-SEP-20S	M27X2	16	65	32	32	TI-SEM-20S
25	BAR	1"	18	30	73	54	46	41	39	TI-SEP-25S	M33X2	18	73	41	39	TI-SEM-25S
30	MAX 120	1 1/4"	20	35.5	78.5	62	50	50	49	TI-SEP-30S	M42X2	20	78.5	50	49	TI-SEM-30S
38	BAR	1 1/2"	22	41	89	72	60	55	55	TI-SEP-38S	M48X2	22	89	55	55	TI-SEM-38S

*Dimensions given are approx. figures with tightened nut.

WELDING ELBOW CONNECTOR WE

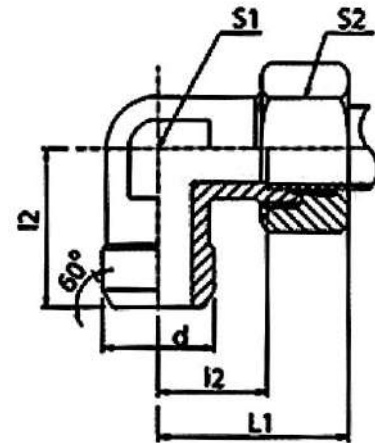

OD OF TUBE	WORKING PRESSURE	d	l ₁	l ₂	L1	S1	S2	PART NO.
6	L	10	12	19	27	12	14	TI-WE-6L
8	LIGHT	12	14	23	29	12	17	TI-WE-8L
10	MAX 250	14	15	24	30	14	19	TI-WE-10L
12	BAR	16	17	25	32	17	22	TI-WE-12L
15		19	21	30	36	19	27	TI-WE-15L
18		22	23.5	33	40	24	32	TI-WE-18L
22	MAX 100	27	27.5	37	44	27	36	TI-WE-22L
28	BAR	32	30.5	42	47	36	41	TI-WE-28L
35		40	34.5	49	56	41	50	TI-WE-35L
42		46	40	57	63	50	60	TI-WE-42L
6	S	11	16	23	31	12	17	TI-WE-6S
8	HEAVY	13	17	24	32	14	19	TI-WE-8S
10	MAX 500	15	17.5	25	34	17	22	TI-WE-10S
12	BAR	17	21.5	29	38	17	24	TI-WE-12S
14		19	22	30	40	19	27	TI-WE-14S
16		21	24.5	33	43	24	30	TI-WE-16S
20	MAX 400	26	26.5	37	48	27	36	TI-WE-20S
25	BAR	31	30	42	54	36	46	TI-WE-25S
30	MAX 200	36	35.5	49	62	41	50	TI-WE-30S
38	BAR	44	41	57	72	50	60	TI-WE-38S

*Dimensions given are approx. figures with tightened nut.

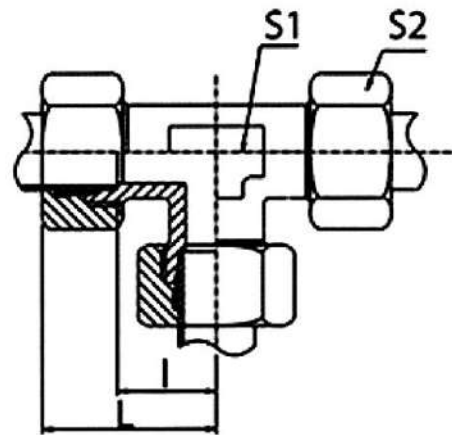
**EQUAL TEE
ET**

Tube OD IN MM	Working Pressure	I	L	S1	S2	Part No.
6	L	12	27	12	14	TI-ET-6L
8	LIGHT	14	29	14	17	TI-ET-8L
10	MAX 250	15	30	14	19	TI-ET-10L
12	BAR	17	32	17	22	TI-ET-12L
15		21	36	19	27	TI-ET-15L
18		23.5	40	24	32	TI-ET-18L
22	MAX 100	27.5	44	27	36	TI-ET-22L
28	BAR	30.5	47	36	41	TI-ET-28L
35		34.5	56	41	50	TI-ET-35L
42		40	63	50	60	TI-ET-42L
6	S	16	31	14	17	TI-ET-6S
8	HEAVY	17	32	14	19	TI-ET-8S
10	MAX 500	17.5	34	17	22	TI-ET-10S
12	BAR	21.5	38	17	24	TI-ET-12S
14		22	40	19	27	TI-ET-14S
16		24.5	43	24	30	TI-ET-16S
20	MAX 400	26.5	48	27	36	TI-ET-20S
25	BAR	30	54	36	46	TI-ET-25S
30	MAX 200	35.5	62	41	50	TI-ET-30S
38	BAR	41	72	50	60	TI-ET-38S

*Dimension given are approx. Figures with tightened nut.

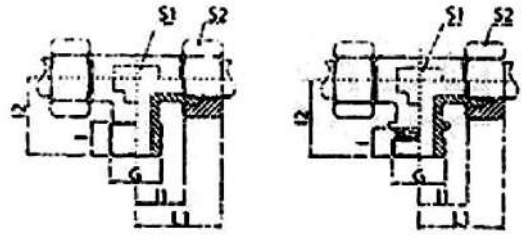
**MALE STUD TEE
TCT/TCB/TCN**

OD of Tube	Working Pressure	G	I	I1	t2	L1	S1	S2	Part No. For BSPT Plug End
		BSPP / NPT							
6	L LIGHT MAX 250 BAR	1/8"	8	12	20	27	12	14	TI-TCT-6L-1/8
8		1/4"	12	14	26	29	14	17	TI-TCT-8L-1/4
10		1/4"	12	15	27	30	17	19	TI-TCT-10L-1/4
12		3/8"	12	17	28	32	19	22	TI-TCT-12L-3/8
15		1/2"	14	21	34	36	19	27	TI-TCT-15L-1/2
18		1/2"	14	24	36	40	24	32	TI-TCT-18L-1/2
6	S HEAVY MAX 350 BAR	1/4"	12	16	26	31	14	17	TI-TCT-6S-1/4
8		1/4"	12	17	27	32	17	19	TI-TCT-8S-1/4
10		3/8"	12	18	28	34	19	22	TI-TCT-10S-3/8
12		3/8"	12	22	28	38	22	24	TI-TCT-12S-3/8
14		1/2"	14	22	32	40	24	27	TI-TCT-14S-1/2
16		1/2"	14	25	32	43	24	30	TI-TCT-16S-1/2

OD of Tube	Working Pressure	G	I	I1	t2	L1	S1	S2	Part No. For BSP Plug End
		BSP							
22	L LIGHT MAX 100 BAR	3/4"	16	27.5	42	44	27	36	TI-TCB-22L-3/4
28		1"	18	30.5	48	47	36	41	TI-TCB-28L-1
35		1 1/4*	20	34.5	54	56	41	50	TI-TCB-35L-1 1/4
42		1 1/2"	22	40	61	63	50	60	TI-TCB-42L-1 1/2
20	S HEAVY MAX 200 BAR	3/4"	16	26.5	42	48	27	36	H F-TCB-20S-3/4
25		1"	18	30	48	54	36	46	TI-TI8-25S-1
30		1 1/4-	20	34	54	62	41	50	TI-TCB-30S-11/4
38	MAX 120 BAR	1 1/2"	22	39	61	72	50	60	TI-TCB-38S-11/2

*Dimensions given are approx. figures with tightened nut.

S1 may vary as per forging tol.

for NPT threads, replace TCT By TCN.

for RUN Tees, suffix (RUN) to the part no.

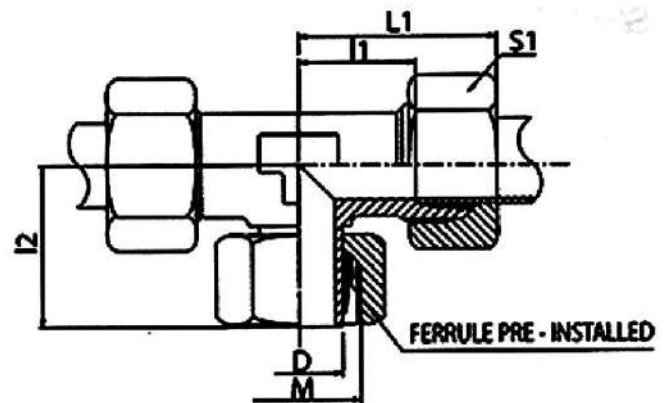
**SWIVEL TEE
TEB/TER**

OD of Tube	Working Pressure	M	D	I ₂	I ₁	L1	S1	PART NO. (BRANCH)
6	L	M12X1.5	6	26	12	27	14	TI-TEB-6L
8	LIGHT	M14X1.5	8	27.5	14	29	17	TI-TEB-8L
10	WAX 250	M16X1.5	10	29	15	30	19	TI-TEB-10L
12	BAR	M18X1.5	12	29.5	17	32	22	TI-TEB-12L
15		M22X1.5	15	32.5	21	36	27	TI-TEB-15L
18		M26X1.5	18	35.5	23.5	40	32	TI-TEB-18L
22	L	M30X2	22	38.5	27.5	44	36	TI-TEB-22L
28	LIGHT	M36X2	28	41.5	30.5	47	41	TI-TEB-28L
35	MAX 100	M45X2	35	51	34.5	56	50	TI-TEB-35L
42	BAR	M52X2	42	56	40	63	60	TI-TEB-42L
6	S	M14X1.5	6	27	16	31	17	TI-TEB-6S
8	HEAVY	M16X1.5	8	27.5	17	32	19	TI-TEB-8S
10	MAX 350	M18X1.5	10	30	17.5	34	22	TI-TEB-10S
12	BAR	M20X1.5	12	31	21.5	38	24	TI-TEB-12S
14		M22X1.5	14	35	22	40	27	TI-TEB-14S
16		M24X1.5	16	36.5	24.5	43	30	TI-TEB-16S
20	MAX 200	M30X2	20	44.5	26.5	48	36	TI-TEB-20S
25	BAR	M36X2	25	50.5	30	54	46	TI-TEB-25S
30	MAX 120	M42X2	30	55	35.5	62	50	TI-TEB-30S
38	BAR	M52X2	38	63	41	72	60	TI-TEB-38S

*Dimensions given are approx. figures with tightened nut.
For Run Swivel Tee, replace TEB by TER.

SWIVEL TET WITH CONNECTOR TEP/TEM

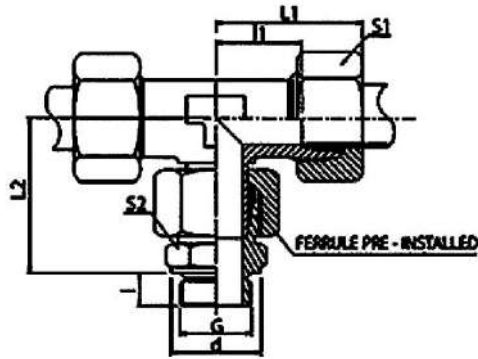

OD of Tube	Working Pressure	G. BSP	I	I ₁	L2	L ₁	S1	S2	d	Part No. BSP	G. Metric	I	L2	S2	d	Part No. Metric
6	L	1/8"	8	12	34.5	27	14	14	14	TI-TEP-6L	M10X1	8	34.5	14	14	TI-TEM-6L
8	LIGHT	1/4"	12	14	37.5	29	17	19	18	TI-TEP-8L	M12X1.5	12	37.5	17	17	TI-TEM-8L
10	MAX 250	1/4"	12	15	40	30	19	19	18	TI-TEP-10L	M14X1.5	12	40	19	19	TI-TEM-10L
12	8AR	3/8"	12	17	43	32	22	22	22	TI-TEP-12L	M16X1.5	12	42	22	21	TI-TEM-12L
15			14	21	46.5	36	27	27	26	TI-TEP-15L	M18X1.5	12	46	24	23	TI-TEM-15L
18		1/2" 1/2"	14	35.5	50	40	32	27	26	TI-TEP-18L	M22X1.5	14	50	27	27	TI-TEM-18L
22	L	3/4"	16	27.5	55	44	36	32	32	TI-TEP-22L	M26X1.5	16	55	32	31	TI-TEM-22L
28	LIGHT	1"	18	30.5	59	47	41	41	39	TI-TEP-28L	M33X2	18	59	41	39	TI-TEM-28L
35	MAX 100	1 1/4"	20	34.5	68.5	56	50	50	49	TI-TEP-35L	M42X2	20	68.5	50	49	TI-TEM-35L
42	BAR	1 1/2"	22	40	75	63	60	55	55	TI-TEP-42L	M48X2	22	79	55	55	TI-TEM-42L
6	S	1/4"	12	16	40	31	17	19	18	TI-TEP-6S	M12X1.5	12	40	17	17	TI-TEM-6S
8	HEAVY	1/4"	12	17	42.5	32	19	19	18	TI-TEP-8S	M14X1.5	12	42.5	19	19	TI-TEM-8S
10	MAX 350	3/8"	12	17.5	45	34	22	22	22	TI-TEP-10S	M16X1.5	12	45	22	21	TI-TEM-10S
12	8AR	3/8"	12	21.5	48	38	24	22	22	TI-TEP-12S	M18X1.5	12	48	24	23	TI-TEM-12S
14		1/2"	14	22	54	40	27	27	26	TI-TEP-14S	M20X1.5	14	54	29	25	TI-TEM-14S
16		1/2"	14	24.5	55	43	30	27	26	TI-TEP-16S	M22X1.5	14	55	27	27	TI-TEM-16S
20	MAX 200	3/4"	16	26.5	65	48	36	32	32	TI-TEP-20S	M27X2	16	65	32	32	TI-TEM-20S
25	8AR	1"	18	30	73	54	46	41	39	TI-TEP-25S	M33X2	18	73	41	39	TI-TEM-25S
30	MAX 120	1 1/4*	20	35.5	78.5	62	50	50	49	TI-TEP-30S	M42X2	20	78.5	50	49	TI-TEM-30S
38	8AR	1 1/2*	22	41	89	72	60	55	55	TI-TEP-38S	M48X2	22	89	55	55	TI-TEM-38S

Dimensions given are approx. figures with tightened nut.
For Run Swivel Tee. Suffix (Run) to part No.

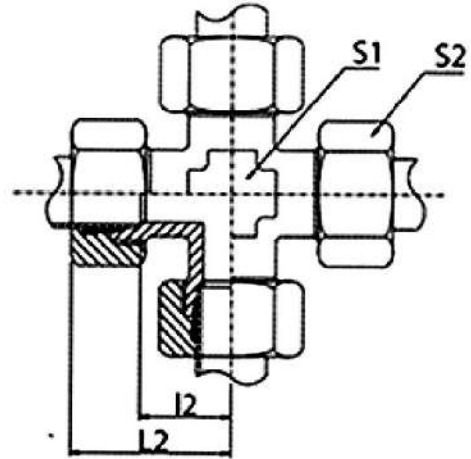
**EQUAL CROSS
EC**

Tube OD IN MM	Working Pressure	l ₂	L ₂	S1	S2	Part No.
6	L	12	27	12	14	TI-EC-6L
8	LIGHT	14	29	12	17	TI-EC-8L
10	MAX 250	15	30	14	19	TI-EC-10L
12	BAR	17	32	17	22	TI-EC-12L
15		21	36	19	27	TI-EC-15L
18		23.5	40	24	32	TI-EC-18L
22	MAX 100	27.5	44	27	36	TI-EC-22L
28	BAR	30.5	47	36	41	TI-EC-28L
35		34.5	56	41	50	TI-EC-35L
42		40	63	50	60	TI-EC-42L
6	S	16	31	12	17	TI-EC-6S
8	HEAVY	17	32	14	19	TI-EC-8S
10	MAX 500	17.5	34	17	22	TI-EC-10S
12	BAR	21.5	38	17	24	TI-EC-12S
14		22	40	19	27	TI-EC-14S
16		24.5	43	24	30	TI-EC-16S
20	MAX 400	26.5	48	27	36	TI-EC-20S
25	BAR	30	54	36	46	TI-EC-25S
30	MAX 200	35.5	62	41	50	TI-EC-30S
38	BAR	41	72	50	60	TI-EC-38S

*Dimension given are approx. Figures with tightened nut.

BULKHEAD COUPLING BHC

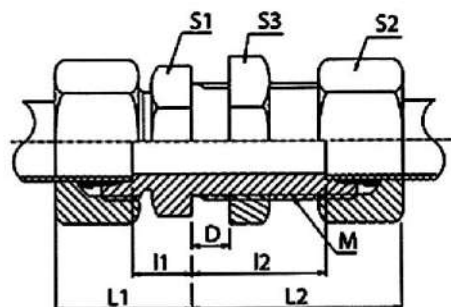

OD of Tube	Working Pressure	M	I ₁	I ₂	L1	L2	S1	S2	S3	Part No.
6	L	M12X1.5	7	27	22	42	17	14	17	TI-BHC-6L
8	LIGHT	M14X1.5	8	27	23	42	19	17	19	TI-BHC-8L
10	MAX 250	M16X1.5	10	28	25	43	22	19	22	TI-BHC-10L
12	BAR	M18X1.5	10	29	25	44	24	22	24	TI-BHC-12L
15		M22X1.5	12	31	27	46	27	27	30	TI-BHC-15L
18		M26X1.5	13.5	32.5	30	49	32	32	36	TI-BHC-18L
22	MAX 100	M30X2	16.5	34.5	33	51	36	36	41	TI-BHC-22L
28	BAR	M36X2	18.5	35.5	35	52	41	41	46	TI-BHC-28L
35		M45X2	18.5	36.5	40	58	50	50	55	TI-BHC-35L
42		M52X2	19	36	42	59	60	60	65	TI-BHC-42L
6	S	M14X1.5	12	29	27	44	19	17	19	TI-BHC-6S
8	HEAVY	M16X1.5	13	29	28	44	22	19	22	TI-BHC-8S
10	MAX 500	M18X1.5	14.5	29.5	31	46	24	22	24	TI-BHC-10S
12	BAR	M20X1.5	14.5	30.5	31	47	27	24	27	TI-BHC-12S
14		M22X1.5	17	32	35	50	30	27	30	TI-BHC-14S
16		M24X1.5	16.5	31.5	35	50	32	30	32	TI-BHC-16S
20	MAX 400	M30X2	17.5	33.5	39	55	41	36	41	TI-BHC-20S
25	BAR	M36X2	20	35	44	59	46	46	46	TI-BHC-25S
30	MAX 200	M42X2	21.5	37.5	48	64	50	50	50	TI-BHC-30S
38	BAR	M52X2	22	37	53	68	65	60	65	TI-BHC-38S

*Dimensions given are approx. figures with tightened nut.
D=16mm, max.

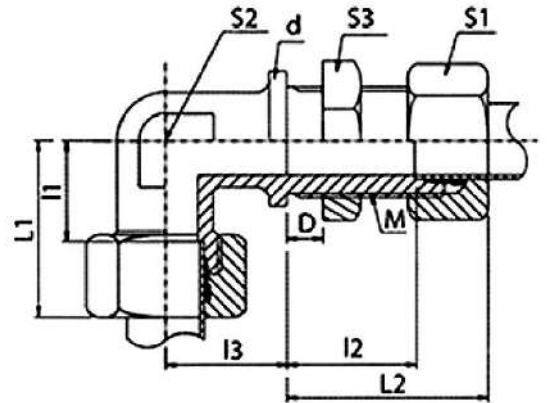
**BULKHEAD ELBOW
BHE**

OD of Tube	Working Pressure	M	d	l ₁	l ₂	l ₃	L1	L2	S1	S2	S3	Part No.
6	L	M12X1.5	17	12	26	14	27	42	14	12	17	TI-BHE-6L
8	LIGHT	M14X1.5	19	14	27.5	17	29	42	17	12	19	TI-BHE-8L
10	MAX 250	M16X1.5	22	15	29	18	30	43	19	14	22	TI-BHE-10L
12	BAR	M18X1.5	24	17	29.5	20	32	44	22	17	24	TI-BHE-12L
15		M22X1.5	27	21	32.5	23	36	46	27	19	30	TI-BHE-15L
18		M26X1.5	32	23.5	35.5	24	40	49	32	24	36	TI-BHE-18L
22	MAX 100	M30X2	36	27.5	38.5	30	44	51	36	27	41	TI-BHE-22L
28	BAR	M36X2	42	30.5	35.5	34	47	52	41	36	46	TI-BHE-28L
35		M45X2	50	34.5	36.5	39	56	58	50	41	55	TI-BHE-35L
42		M52X2	60	40	36	43	63	59	60	50	65	TI-BHE-42L
6	S	M14X1.5	19	16	29	17	31	44	17	12	19	TI-BHE-6S
8	HEAVY	M16X1.5	22	17	29	18	32	44	19	14	22	TI-BHE-8S
10	MAX 500	M18X1.5	24	17.5	29.5	20	34	46	22	17	24	TI-BHE-10S
12	BAR	M20X1.5	27	21.5	30.5	21	38	47	24	17	27	TI-BHE-12S
14		M22X1.5	27	22	32	23	40	50	27	19	30	TI-BHE-14S
16		M24X1.5	30	24.5	31.5	24	43	50	30	24	32	TI-BHE-16S
20	MAX 400	M30X2	36	26.5	33.5	30	48	55	36	27	41	TI-BHE-20S
25	BAR	M36 X2	42	30	35	34	54	59	46	36	46	TI-BHE-25S
30		M42X2	50	35.5	37.5	39	62	64	50	41	50	TI-BHE-30S
38	MAX 200	M52X2	60	41	37	43	72	68	60	50	65	TI-BHE-38S
	BAR											

*Dimensions given are approx. figures with tightened nut.
D=16mm, max.

WELDING BULKHEAD COUPLING WBHC

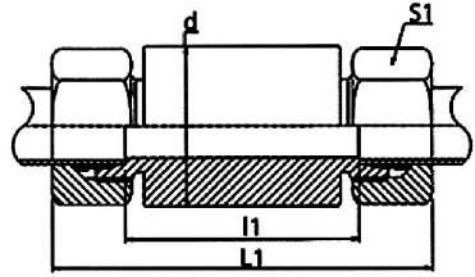

OD OF TUBE	WORKING PRESSURE	d	l ₁	L ₁	S ₁	PART NO.
6	L	18	56	85	14	TI-WBHC-6L
8	LIGHT	20	56	85	17	TI-WBHC-8L
10	MAX 250	22	58	87	19	TI-WBHC-10L
12	BAR	25	58	87	22	TI-WBHC-12L
15		28	70	100	27	TI-WBHC-15L
18		32	69	101	32	TI-WBHC-18L
22	MAX 100	36	73	105	36	TI-WBHC-22L
28	BAR	40	73	106	41	TI-WBHC-28L
35		50	71	114	50	TI-WBHC-35L
42		60	70	115	60	TI-WBHC-42L
6	S	20	60	89	17	TI-WBHC-6S
8	HEAVY	22	60	89	19	TI-WBHC-8S
10	MAX 500	25	59	91	22	TI-WBHC-10S
12	BAR	28	59	91	24	TI-WBHC-12S
14		30	72	107	27	TI-WBHC-14S
16		35	71	107	30	TI-WBHC-16S
20	MAX 400	38	71	114	36	TI-WBHC-20S
25	BAR	45	72	120	46	TI-WBHC-25S
30	MAX 200	50	73	126	50	TI-WBHC-30S
38	BAR	60	72	133	60	TI-WBHC-38S

*Dimensions given are approx. figures with tightened nut.

**ADJUSTABLE PIPE CONNECTOR/BANJO
(WITH COPPER WASHER)
BHE**

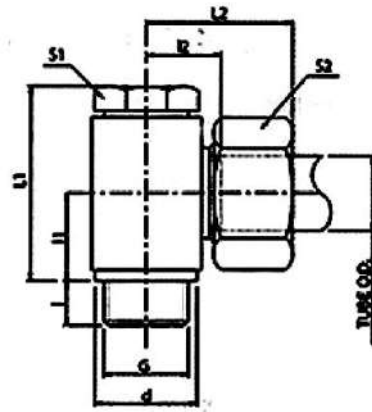

OD of Tube	Working Pressure	G	d	l	l ₁	l ₂	L ₂	L ₁	S ₁	S ₂	Part No.
		BSPP									
6	L LIGHT MAX 250 BAR	1/8"	14	8	12	12.5	28	28	14	14	TI-APC-6L-1/8
8		1/4"	19	12	15.5	14	29	34	19	17	TI-APC-8L-1/4
10		1/4"	19	12	18	15.5	31	34	19	19	TI-APC-10L-1/4
12		3/8"	22	12	18	17.5	33	39	22	22	TI-APC-12L-3/8
15		1/2"	27	14	20	20	35	46	27	27	TI-APC-15L-1/2
18		1/2"	27	14	20	19.5	36	46	27	32	TI-APC-18L-1/2
22	MAX 100 BAR	3/4"	32	16	25.5	27	44	60	32	36	TI-APC-22L-3/4
28		1"	41	18	29	29.5	46	67	41	41	TI-APC-28L-1
35		1 1/4"	50	20	34	33	55	78	50	50	TI-APC-35L-1 1/4
42		1 1/2"	55	22	41.5	40	63	88	55	60	TI-APC-42L-1 1/2
6	S HEAVY MAX 350 BAR	1/4"	19	12	15.5	16	31	34	19	17	TI-APC-6S-1/4
8		1/4"	19	12	15.5	16	31	34	19	19	TI-APC-8S-1/4
10		3/8"	22	12	18	18	35	39	22	22	TI-APC-10S-3/8
12		3/8"	22	12	18	18	35	39	22	24	TI-APC-12S-3/8
14		1/2"	27	14	21	22	40	46	27	27	TI-APC-14S-1/2
16	MAX 200 BAR	1/2"	27	14	21	21.5	40	46	27	30	TI-APC-16S-1/2
20		3/4"	32	16	28	28.5	50	60	32	36	TI-APC-20S-3/4
25		1"	41	18	31	31	55	67	41	46	TI-APC-25S-1
30	MAX 120 BAR	1 1/4"	50	20	36.5	36.5	63	78	50	50	TI-APC-30S-1 1/4
38		1 1/2"	55	22	41.5	41	72	88	55	60	TI-APC-38S-1 1/2

*Dimensions given are approx. figures with tightened nut.

**THROTTLE FREE BANJO
(WITH COPPER WASHERS)
TFB**

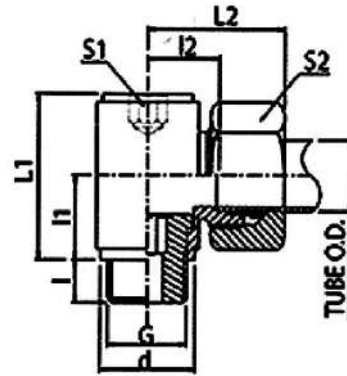

OD of Tube	Working Pressure	G	d	l	l ₁	l ₂	L ₂	L ₁	S ₂	S ₁	Part No.
		BSPP									
6	L LIGHT MAX 250 BAR	1/8"	14	8	12	12.5	27	24	14	6	TI-TFB-6L-1/8
8		1/4"	18	12	16	14.5	29	30	17	8	TI-TFB-8L-1/4
10		1/4"	18	12	16	15.5	30	30	19	8	TI-TFB-10L-1/4
12		3/8"	22	12	18	18.5	33	37	22	10	TI-TFB-12L-3/8
15		1/2"	26	14	21	22	37	42	27	12	TI-TFB-15L-1/2
18		1/2"	26	14	23	21.5	38	46	32	12	TI-TFB-18L-1/2
22	MAX 100 BAR	3/4"	32	16	28	28.5	45	58	36	17	TI-TFB-22L-3/4
28		1"	39	18	32	31.5	48	64	41	22	TI-TFB-28L-1
35		1 1/4"	49	20	37	35.5	57	76	50	27	TI-TFB-35L-1 1/4
42		1 1/2"	55	22	42	40	63	85	60	32	TI-TFB-42L-1 1/2
6	S HEAVY MAX 350 BAR	1/4"	18	12	16	16.5	31	30	17	8	TI-TFB-6S-1/4
8		1/4"	18	12	16	16.5	31	30	19	8	TI-TFB-8S-1/4
10		3/8"	22	12	18	18.5	35	37	22	10	TI-TFB-10S-3/8
12		3/8"	22	12	18	18.5	35	37	24	10	TI-TFB-12S-3/8
14		1/2"	26	14	21	23	41	42	27	12	TI-TFB-14S-1/2
16		1/2"	26	14	23	22.5	41	46	30	12	TI-TFB-16S-1/2
20	MAX 200 BAR	3/4"	32	16	28	27.5	49	58	36	17	TI-TFB-20S-3/4
25		1"	39	18	32	31	55	64	46	22	TI-TFB-25S-1
30		1 1/4"	49	20	37	36.5	63	76	50	27	TI-TFB-30S-1 1/4
38	1 1/2"	55	22	42	41	72	85	60	32	TI-TFB-38S-1 1/2	

*Dimensions given are approx. figures with tightened nut.

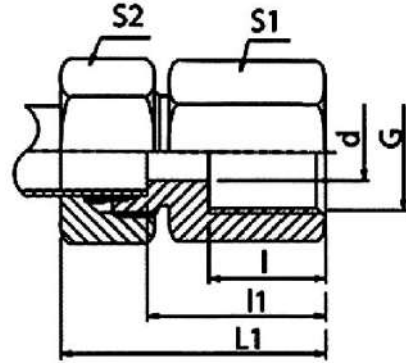
**FEMALE CONNECTOR
FSB/FSM**

OD of Tube	Working Pressure	G		d	l	l ₁	L1	S1	S2	Part No. For BSP Thread
		BSP	Metric							
6	L LIGHT MAX 250 BAR	1/8"	M10X1	4	12	19	34	14	14	TI-FSB-6L-1/8
8		1/4"	M12X1.5	6	17	24	39	19	17	TI-FSB-8L-1/4
10		1/4"	M14X1.5	8	17	25	40	19	19	TI-FSB-10L-1/4
12		3/8"	M16X1.5	10	17	26	41	22	22	TI-FSB-12L-3/8
15		1/2"	M18X1.5	12	20	31	46	27	27	TI-FSB-15L-1/2
18		1/2"	M22X1.5	15	20	30.5	47	27	32	TI-FSB-18L-1/2
22	MAX 100 BAR	3/4"	M26X1.5	19	22	35.5	52	32	36	TI-FSB-22L-3/4
28		1"	M33X2	24	24.5	38	55	41	41	TI-FSB-28L-1
35		1 1/4"	M42X2	30	26.5	41	63	50	50	TI-FSB-35L-1 1/4
42		1 1/2*	M48X2	36	28.5	42.5	65	55	60	TI-FSB-42L-1 1/2
6	S HEAVY MAX 350 BAR	1/4"	M12X1.5	4	17	26	41	19	17	TI-FSB-6S-1/4
8		1/4"	M14X1.5	5	17	26	41	19	19	TI-FSB-8S-1/4
10		3/8"	M16X1.5	7	17	26.5	43	24	22	TI-FSB-10S-3/8
12		3/8"	M18X1.5	8	17	26.5	43	24	24	TI-FSB-12S-3/8
14		1/2"	M20X1.5	10	20	32	50	30	27	TI-FSB-14S-1/2
16		1/2"	M22X1.5	12	20	31.5	50	30	30	TI-FSB-16S-1/2
20	MAX 200 BAR	3/4"	M27X2	16	22	34.5	56	36	36	TI-FSB-20S-3/4
25		1"	M33X2	20	24.5	37.5	62	41	46	TI-FSB-25S-1
30		1 1/4"	M42X2	25	26.5	42	69	55	50	TI-FSB-30S-1 1/4
38	MAX 120 BAR	1 1/2"	M48X2	32	28.5	43.5	74	60	60	TI-FSB-38S-1 1/2

*Dimensions given are approx. figures with tightened nut.
For Metric thread, replace FSB by FSM.
Other combinations can also be supplied.

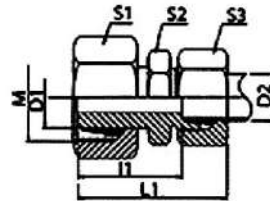

TUBE REDUCER KOR

OD of Tube D1	OD of Tube D2	Working Pressure	M	l ₁	L1	S1	S2	S3	PART NO.
z	6	250 BAR	M14X1.5	23.5	38	17	12	14	TI-KOR-8L/6L
10	6	250 BAR	M16X1.5	25	40	19	14	14	TI-KOR-10L/6L
10	8		M16X1.5	25	40	19	14	17	TI-KOR-10L/8L
12	6	250 BAR	M18X1.5	25	40	22	17	14	TI-KOR-12L/6L
12	8		M18X1.5	25	40	22	17	17	TI-KOR-12L/8L
12	10		M18X1.5	26	41	22	17	19	TI-KOR-12L/10L
15	6	250 BAR	M22X1.5	28.5	43	27	19	14	TI-KOR-15L/6L
15	8		M22X1.5	28.5	43	27	19	17	TI-KOR-15L/8L
15	10		M22X1.5	29.5	44	27	19	19	TI-KOR-15L/10L
15	12		M22X1.5	29.5	44	27	19	22	TI-KOR-15L/12L
18	6	250 BAR	M26X1.5	28	43	32	24	14	TI-KOR-18L/6L
18	8		M26X1.5	28	43	32	24	17	TI-KOR-18L/8L
18	10		M26X1.5	29	44	32	24	19	TI-KOR-18L/10L
18	12		M26X1.5	29	44	32	24	22	TI-KOR-18L/12L
18	15		M26X1.5	30	45	32	24	27	TI-KOR-18L/15L
22	6	100 BAR	M30X2	32	47	36	27	14	TI-KOR-22L/6L
22	8		M30X2	32	47	36	27	17	TI-KOR-22L/8L
22	10		M30X2	33	48	36	27	19	TI-KOR-22L/10L
22	12		M30X2	33	48	36	27	22	TI-KOR-22L/12L
22	15		M30X2	34	49	36	27	27	TI-KOR-22L/15L
22	18		M30X2	33.5	50	36	27	32	TI-KOR-22L/18L
28	6	100 BAR	M36X2	34	49	41	32	14	TI-KOR-28L/6L
28	8		M36X2	34	49	41	32	17	TI-KOR-28L/8L
28	10		M36X2	35	50	41	32	19	TI-KOR-28L/10L
28	12		M36X2	35	50	41	32	22	TI-KOR-28L/12L
28	15		M36X2	36	51	41	32	27	TI-KOR-28L/15L
28	18		M36X2	35.5	52	41	32	32	TI-KOR-28L/18L
28	22		M36X2	37.5	54	41	32	36	TI-KOR-28L/22L
35	6	100 BAR	M45X2	37	52	50	41	14	TI-KOR-35L/6L
35	8		M45X2	37	52	50	41	17	TI-KOR-35L/8L
35	10		M45X2	38	53	50	41	19	TI-KOR-35L/10L
35	12		M45X2	38	53	50	41	22	TI-KOR-35L/12L
35	15		M45X2	39	54	50	41	27	TI-KOR-35L/15L
35	18		M45X2	38.5	55	50	41	32	TI-KOR-35L/18L
35	22		M45X2	40.5	57	50	41	36	TI-KOR-35L/22L
35	28		M45X2	40.5	57	50	41	41	TI-KOR-35L/28L
42	10	100 BAR	M52X2	41.5	56	60	50	19	TI-KOR-42L/10L
42	12		M52X2	41.5	56	60	50	22	TI-KOR-42L/12L
42	15		M52X2	42.5	58	60	50	27	TI-KOR-42L/15L
42	18		M52X2	42	58	60	50	32	TI-KOR-42L/18L
42	22		M52X2	44	60	60	50	36	TI-KOR-42L/22L
42	28		M52X2	44	61	60	50	41	TI-KOR-42L/28L
42	35		M52X2	43	65	60	50	50	TI-KOR-42L/35L

*Dimensions given are approx. figures with tightened nut.

TUBE REDUCER KOR

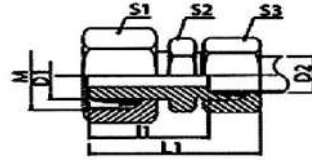

OD of Tube D1	OD of Tube D2	Working Pressure	M	I1	L1	S1	S2	S3	PART NO.
8	6	500 BAR	M16X1.5	27	42	19	14	17	TI-KOR-8S/6S
10	6	500 BAR	M18X1.5	27.5	42	22	17	19	TI-KOR-10S/6S
10	8		M18X1.5	27.5	42	22	17	22	TI-KOR-10S/8S
12	6	500 BAR	M20X1.5	29	44	24	17	17	TI-KOR-12S/6S
12	8		M20X1.5	29	44	24	17	19	TI-KOR-12S/8S
12	10		M20X1.5	29.5	46	24	19	22	TI-KOR-12S/10S
14	6	500 BAR	M22X1.5	31.5	46	27	19	17	TI-KOR-14S/6S
14	8		M22X1.5	31.5	46	27	19	19	TI-KOR-14S/8S
14	10		M22X1.5	31	47	27	19	22	TI-KOR-14S/10S
14	12		M22X1.5	31	47	27	22	24	TI-KOR-14S/12S
16	6	400 BAR	M24X1.5	32	47	30	22	17	TI-KOR-16S/6S
16	8		M24X1.5	32	47	30	22	19	TI-KOR-16S/8S
16	10		M24X1.5	31.5	48	30	22	22	TI-KOR-16S/10S
16	12		M24X1.5	31.5	48	30	22	24	TI-KOR-16S/12S
16	14		M24X1.5	33	51	30	24	27	TI-KOR-16S/14S
20	6	400 BAR	M30X2	36	51	36	27	17	TI-KOR-20S/6S
20	8		M30X2	36	51	36	27	19	TI-KOR-20S/8S
20	10		M30X2	35.5	52	36	27	22	TI-KOR-20S/10S
20	12		M30X2	35.5	52	36	27	24	TI-KOR-20S/12S
20	14		M30X2	37	55	36	27	27	TI-KOR-20S/14S
20	16		M30X2	36.5	55	36	27	30	TI-KOR-20S/16S
25	6	400 BAR	M36X2	38.5	53	46	32	17	TI-KOR-25S/6S
25	8		M36X2	38.5	53	46	32	19	TI-KOR-25S/8S
25	10		M36X2	38	54	46	32	22	TI-KOR-25S/10S
25	12		M36X2	38	54	46	32	24	TI-KOR-25S/12S
25	14		M36X2	39.5	57	46	32	27	TI-KOR-25S/14S
25	16		M36X2	39	57	46	32	30	TI-KOR-25S/16S
25	20		M36X2	39	61	46	32	36	TI-KOR-25S/20S
30	6	200 BAR	M42X2	44	59	50	41	17	TI-KOR-30S/6S
30	8		M42X2	44	59	50	41	19	TI-KOR-30S/8S
30	10		M42X2	43.5	60	50	41	22	TI-KOR-30S/10S
30	12		M42X2	43.5	60	50	41	24	TI-KOR-30S/12S
30	14		M42X2	45	63	50	41	27	TI-KOR-30S/14S
30	16		M42X2	44.5	63	50	41	30	TI-KOR-30S-16S
30	20		M42X2	44.5	66	50	41	36	TI-KOR-30S/20S
30	25		M42X2	45	69	50	41	46	TI-KOR-30S/25S
38	6	200 BAR	M52X2	47.5	62	60	50	17	TI-KOR-38S/6S
38	8		M52X2	47.5	62	60	50	19	TI-KOR-38S/8S
38	10		M52X2	47	63	60	50	22	TI-KOR-38S/10S
38	12		M52X2	47	63	60	50	24	TI-KOR-38S/12S
38	14		M52X2	48.5	66	60	50	27	TI-KOR-38S/14S
38	16		M 52X2	48	66	60	50	30	TI-KOR-38S/16S
38	20		M 52X2	48	70	60	50	36	TI-KOR-38S/20S
38	25		M 52X2	48.5	73	60	50	46	TI-KOR-38S/25S
38	30		M 52X2	49	76	60	50	50	TI-KOR-38S/30S

*Dimensions given are approx. figures with tightened nut.

PRESSURE GAUGE CONNECTOR MC

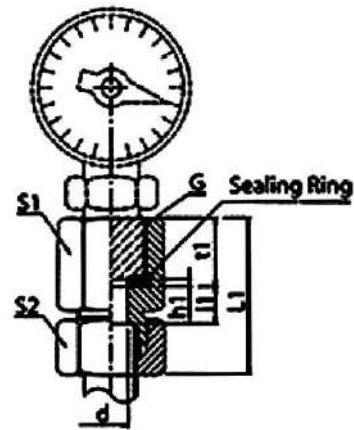

OD Tube	Working Pressure	G	d	h ₁	t ₁	l ₁	L1	S1	S2	PART NO. (BRANCH)
6	L	1/4"	2.5	4.5	14.5	7.5	37	19	14	TI-MC-6L-1/4
8	LIGHT	1/4"	5.5	4.5	14.5	7.5	37	19	17	TI-MC-8L-1/4
10	MAX 250	1/4"	5.5	4.5	14.5	8.5	38	19	19	TI-MC-10L-1/4
12	BAR	1/4"	5.5	4.5	14.5	8.5	38	19	22	TI-MC-12L-1/4
6	S HEAVY MAX 350 BAR	3/8"	3.5	4.5	16.5	9.5	41	22	17	TI-MC-6S-3/8
6		1/2"	3.5	5	20	11	46	27	17	TI-MC-6S-1/2
8		3/8"	3.5	4.5	16.5	9.5	41	22	19	TI-MC-8S-3/8
8		1/2"	3.5	5	20	11	46	27	19	TI-MC-8S-1/2
10		3/8"	7.5	4.5	16.5	9	42	22	22	TI-MC-10S-3/8
10		1/2"	7.5	5	20	10.5	47	27	22	TI-MC-10S-1/2
12		3/8"	7.5	4.5	16.5	9	42	22	24	TI-MC-12S-3/8
12		1/2"	7.5	5	20	10.5	47	27	24	TI-MC-12S-1/2

*Dimensions given are approx. figures with tightened nut.

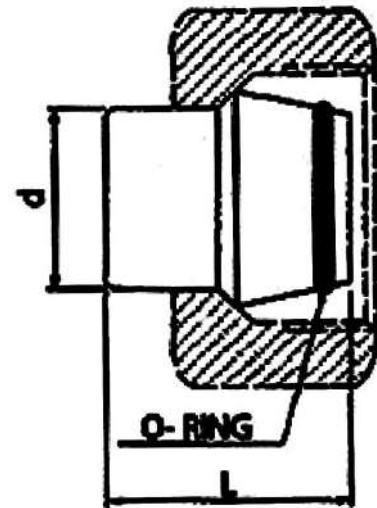
**BLANKING PLUG
BP**

TUBE OD IN MM	WORKING PRESSURE	L	O' RING	PART NO.
6	L	18.5	4.5X1.5	TI-BP-6L
8	LIGHT	18.5	6.5X1.5	TI-BP-8L
10	MAX 250	20	8X1.5	TI-BP-10L
12	BAR	20.5	10X1.5	TI-BP-12L
15		20.5	12X2	TI-BP-15L
18		22.5	15X2	TI-BP-18L
22	MAX 100	25	20X2	TI-BP-22L
28	BAR	25.5	26X2	TI-BP-28L
35		30	32 X 2.5	TI-BP-35L
42		30	38X2.5	TI-BP-42L
6	S	18.5	4.5X1.5	TI-BP-6S
8	HEAVY	18.5	6.5X1.5	TI-BP-8S
10	MAX 500	20	8X1.5	TI-BP-10S
12	BAR	20.5	10X1.5	TI-BP-12S
14		22.5	11X2	TI-BP-14S
16		23.5	13X2	TI-BP-16S
20	MAX 400	28.5	16.3X2.4	TI-BP-20S
25	BAR	29	20.3X2.4	TI-BP-25S
30	MAX 200	30.5	25.3X2.4	TI-BP-30S
38	BAR	33	33.3 X 2.4	TI-BP-38S